

1 2 3 4 5 6

B

A

B

C

D

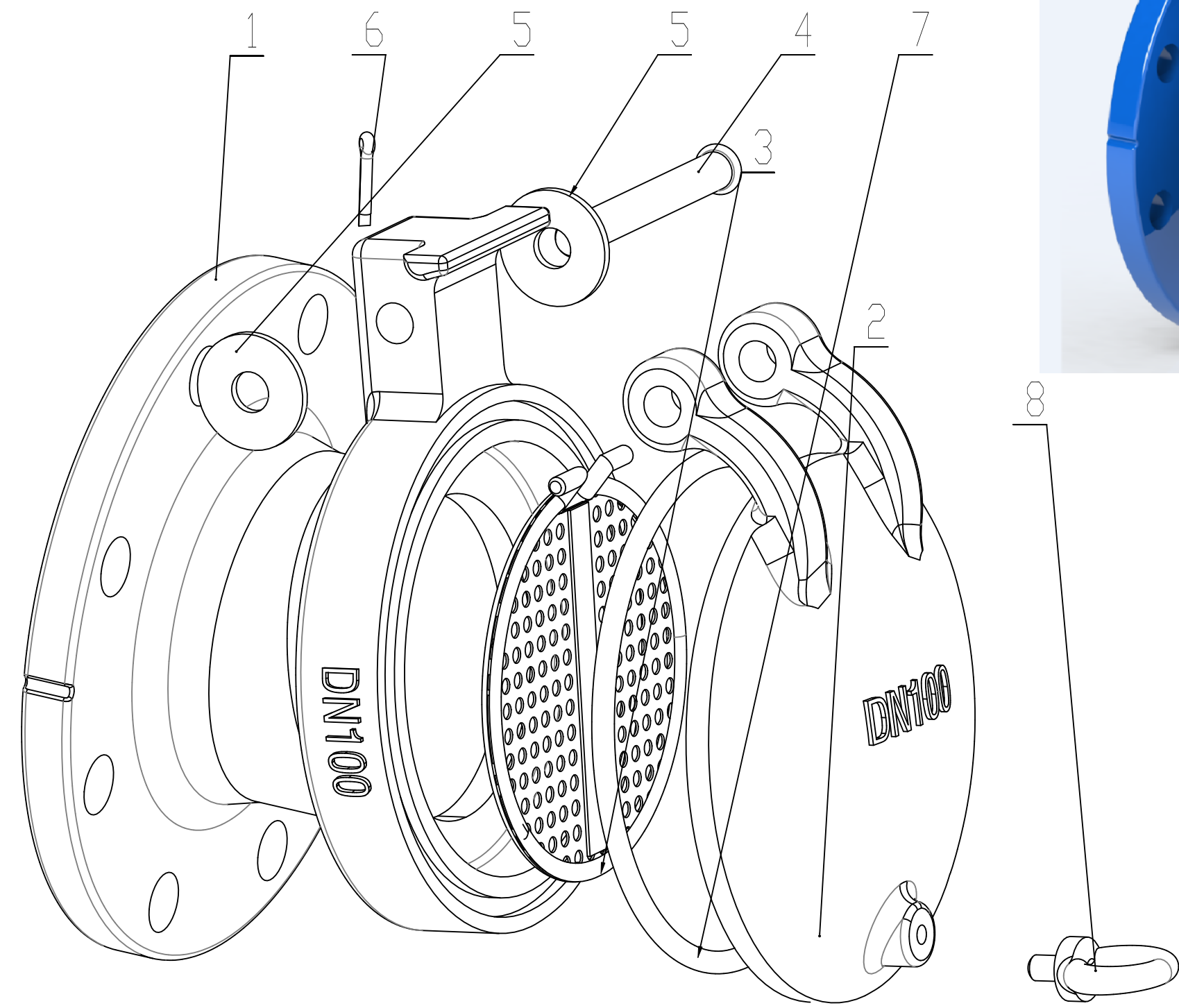

Item	Parts Name	Material	Quantity
1	Body	GGG50	1
2	Bonnet	GGG50	1
3	Screen	SS304	1
4	Pin	SS304	1
5	Metal gasket	SS304	2
6	Clip	SS304	1
7	Gasket	EPDM	1
8	Lifting ring	CARBON STEEL	1

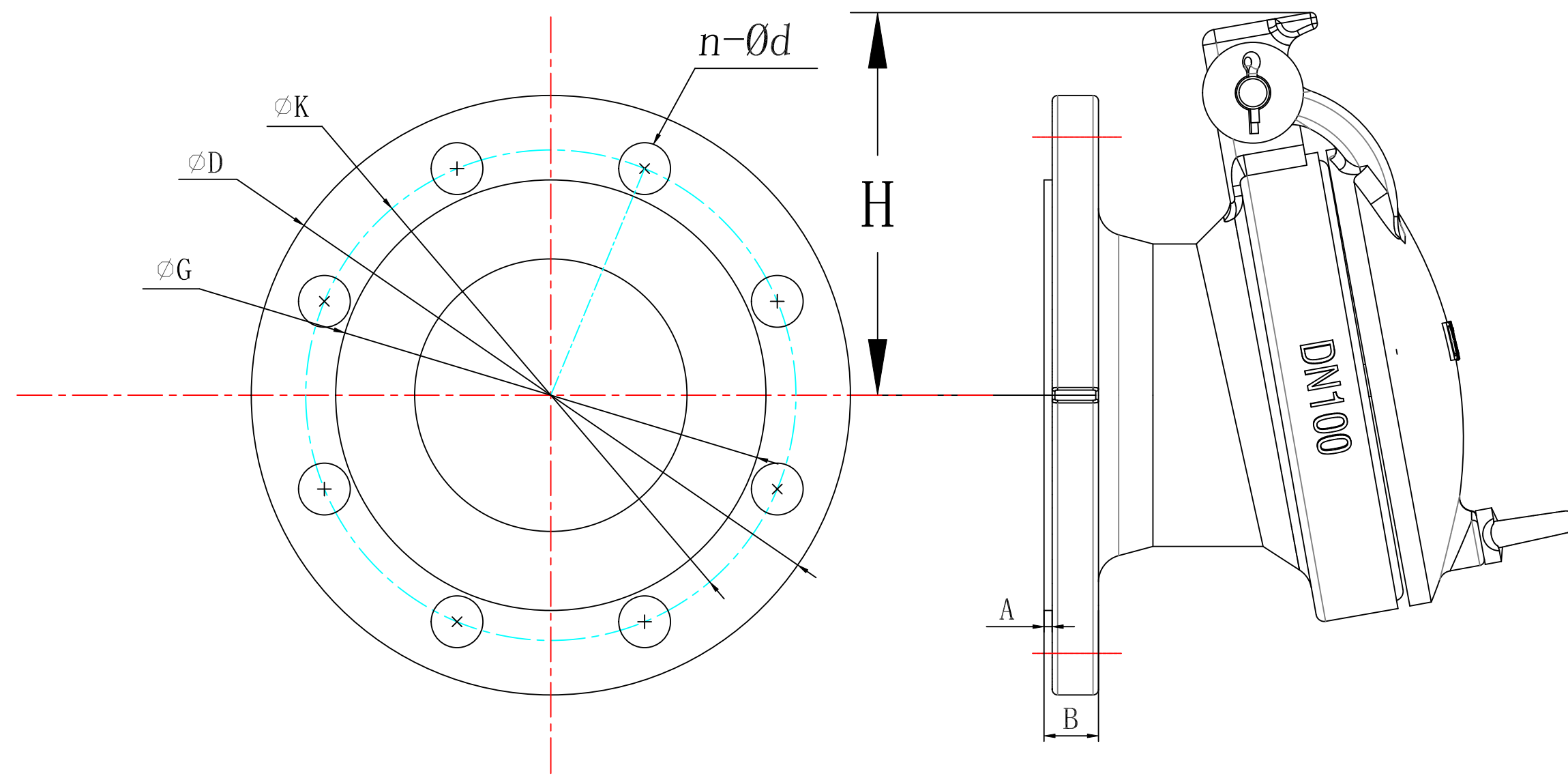

DN	ØD		ØK		ØG		n-Ød		A	B
	PN10	PN16	PN10	PN16	PN10	PN16	PN10	PN16		
DN50	Ø165	Ø165	Ø125	Ø125	Ø102	Ø102	4-Ø19	4-Ø19	3	19
DN65	Ø185	Ø185	Ø145	Ø145	Ø122	Ø122	4-Ø19	4-Ø19	3	19
DN80	Ø200	Ø200	Ø160	Ø160	Ø138	Ø138	8-Ø19	8-Ø19	3	19
DN100	Ø220	Ø220	Ø180	Ø180	Ø158	Ø158	8-Ø19	8-Ø19	3	19
DN125	Ø250	Ø250	Ø210	Ø210	Ø188	Ø188	8-Ø19	8-Ø19	3	19
DN150	Ø285	Ø285	Ø240	Ø240	Ø212	Ø212	8-Ø23	8-Ø23	3	19
DN200	Ø340	Ø340	Ø295	Ø295	Ø268	Ø268	8-Ø23	12-Ø23	3	20
DN250	Ø405	Ø405	Ø350	Ø355	Ø320	Ø325	12-Ø23	12-Ø27	3	22
DN300	Ø460	Ø460	Ø400	Ø410	Ø370	Ø378	12-Ø 3	12-Ø27	3	25
DN400	580	580	515	525	482	490	16-Φ27	16-Φ31	4	28
DN600	840	840	725	770	690	727	20-Φ31	20-Φ37	4	36

Application

- 1、Flange drilled is according to EN1092-2,
- 2、Working temperature:-20° ~80°C,
- 3、working pressure:PN10-PN16.

Flap Valve

1 2 3 4 5 6