

1 2 3 4 5 6 7 8

OVER ALL DIMENSIONS

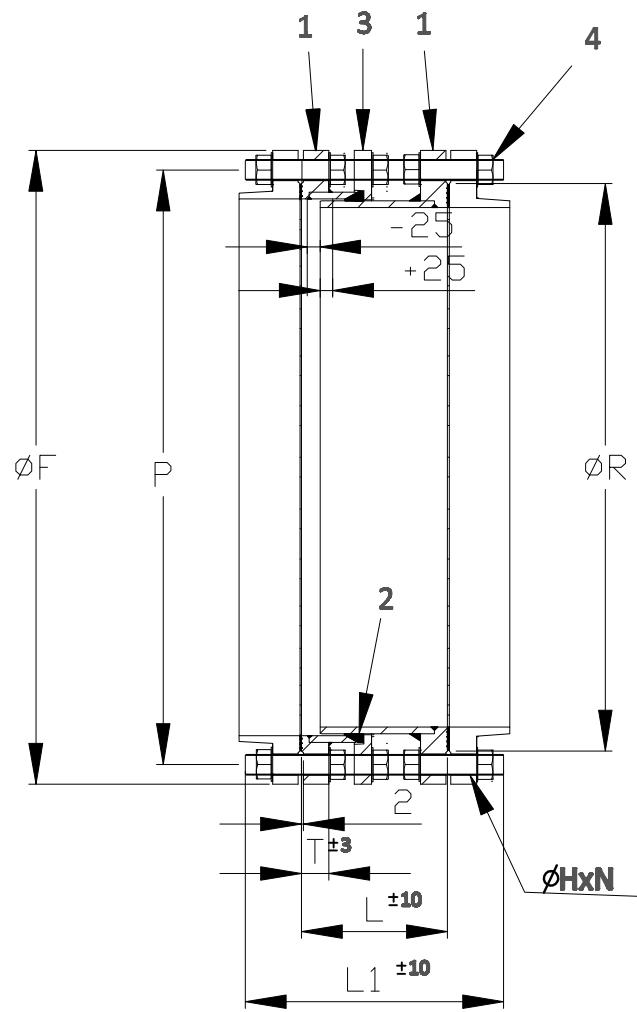
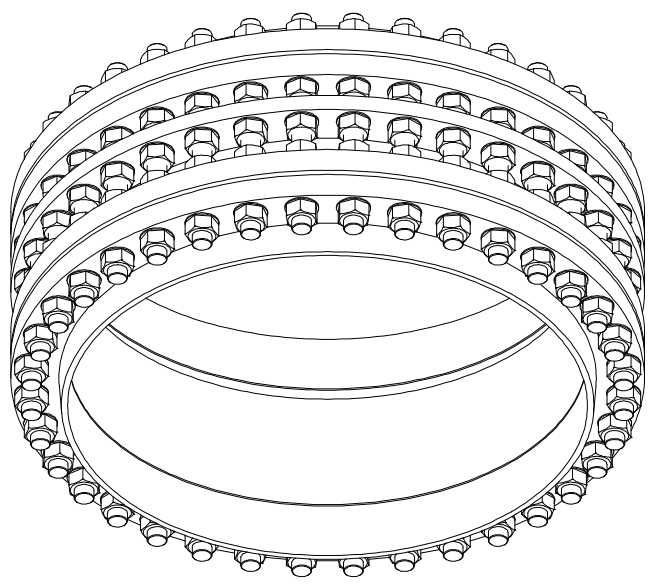
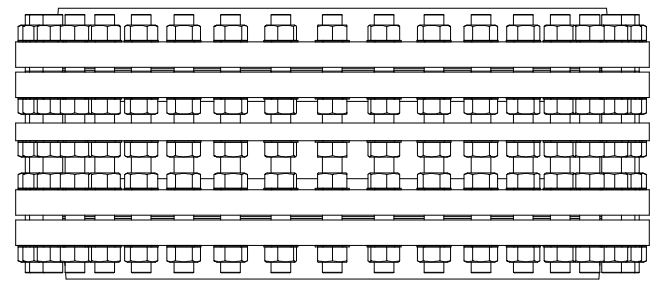

SIZE (mm)	L	L1	Ø F	Ø R	T	N	STUD DIA.	Ø H	P
100 NB	200	310	229	157	17	8	5/8"x11 UNC	19	190.5
150 NB	200	320	279	216	17	8	3/4"x10 UNC	22.2	241
200 NB	220	350	343	270	22	8	3/4"x10 UNC	22.2	298.5
250 NB	230	370	406	324	22	12	7/8"x9 UNC	25.4	362
300 NB	250	410	483	381	22	12	7/8"x9 UNC	25.4	432
400 NB	270	430	597	470	28	16	1"x8 UNC	28.5	540
500 NB	280	460	699	584	28	20	1-1/8"x8 UNC	31.7	635
600 NB	300	500	813	692	32	20	1-1/4"x8 UNC	35	749
700 NB	300	550	927	800	32	28	1-1/4"x8 UNC	35	864
800 NB	320	600	1060	914	37	28	1-1/2"x8 UNC	41.3	978
900 NB	320	620	1168	1022	37	32	1-1/2"x8 UNC	41.3	1086
1000 NB	340	640	1289	1124	37	36	1-1/2"x8 UNC	41.3	1200
1200 NB	360	690	1511	1359	47	44	1-1/2"x8 UNC	41.3	1422
1400 NB	380	760	1746	1575	47	48	1-3/4"x8 UNC	47.6	1651
1500 NB	410	800	1854	1676	47	52	1-3/4"x8 UNC	47.6	1759
1600 NB	410	740	2032	—	47	52	1-3/4"x8 UNC	47.6	1930

NOTE:- 1)PLEASE NOTE THAT DN1600 DO NOT HAVE RAISED FACE DIAMETER.
2)FLANGE DRILLING AS PER ASME B 16.5 & ASME B 16.47 SER."A"

SR NO	PART	MATERIAL
1	FLANGE	Q235
2	SEAL RING	EPDM
3	FOLLOWER	Q235
4	STUD/NUT	35Crmo

TEST PRESSURE BAR
HYDROSTATIC (AWWA C219)
BODY
20

NOTE:-
(1) INTERNAL HIGH QUALITY EPOXY PAINTING OF 2 to 3 COATS (200 TO 300 MIC)
(2) EXTERNAL HIGH QUALITY EPOXY PAINTING OF 2 to 3 COATS (200 TO 300 MIC)

CUSTOMER:-	SCALE: N.T.S.		
YOUR REF.NO:- RFQ DJ - SWCC	SIZE:-AS ABOVE	ALL DIMENSIONS ARE IN"mm" UNLESS & OTHERWISE STATED	
OUR REF.NO:- IVC / 0509 /00	RATING:-150#		
DESCRIPTION:- G.A.FOR FABRICATED DISMANTLING JOINTS	PROJECTION 	FILE NO.:-DMJ -GA -150	SHEET:1 OF 1
		DRG. NO.-IVC/0509/01	

1 2 3 4