

**NUTS AS PER DIN934,CARBON STEEL
 GRADE 4.8/6.8/8.8 WITH DACROMET
 THICKNESS 8-10UM/HOT DIP
 GALVANIZATION 30-40UM/STAINLESS
 STEEL A2/A4 OR AS PER CLIENT
 REQUIREMENT**

**WASHER AS PER DIN125,SPRING WASHER AS
 PER DIN127, CARBON STEEL GRADE 4.8/6.8/8.8
 WITH DACROMET THICKNESS 8-10UM/HOT DIP
 GALVANIZATION 30-40UM/STAINLESS STEEL
 A2/A4 OR AS PER CLIENT REQUIREMENT**

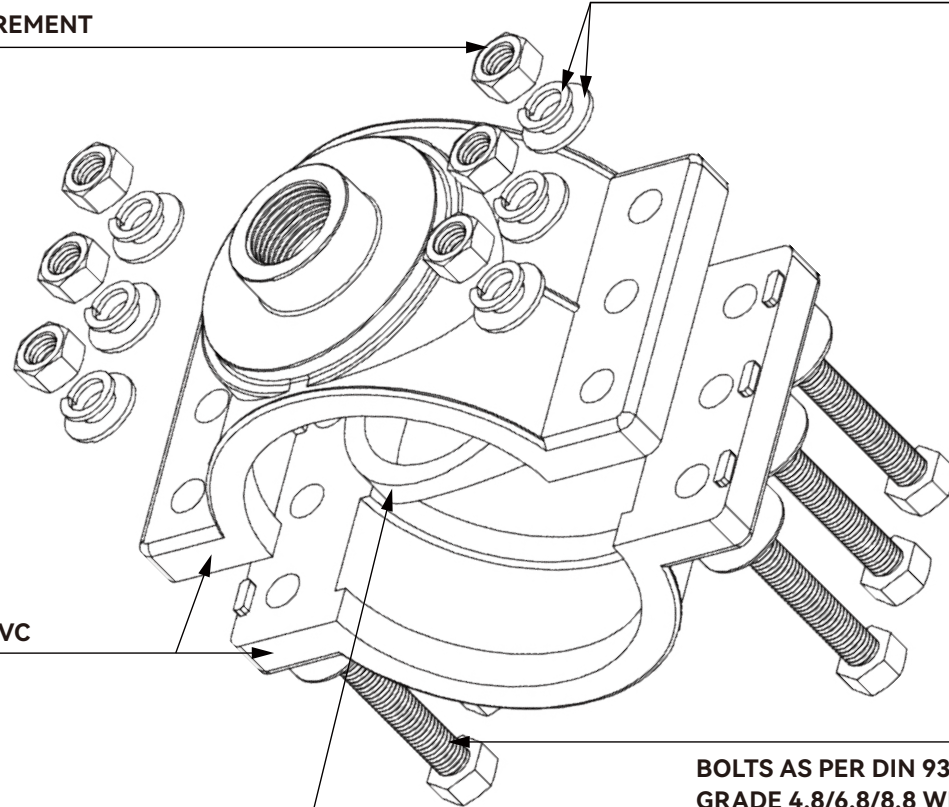
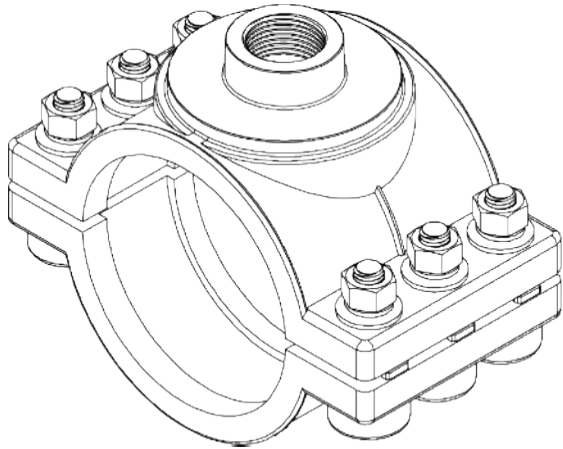

Body PVC

**GASKET
 EPDM AS PER EN681-1
 OR NBR AS PER EN682**

**BOLTS AS PER DIN 933,CARBON STEEL
 GRADE 4.8/6.8/8.8 WITH DACROMET
 THICKNESS 8-10UM/HOT DIP
 GALVANIZATION 30-40UM/STAINLESS
 STEEL A2/A4 OR AS
 PER CLIENT REQUIREMENT**

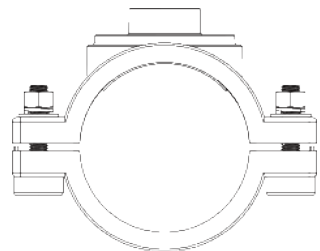
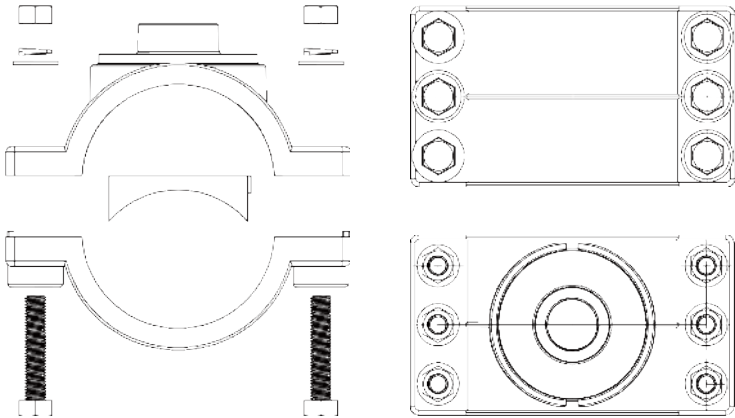

PRECAUTIONS

- 1,Suitable for PVC pipes.
- 2,Sealing is achieved by sealing function thread of saddle clamp and isolation valve. The opening and closing of the branch pipeline are controlled by isolation valve.
- 3,Medium conveyed can be water ,oil or gas.

UNLESS OTHERWISE SPECIFIED, DIMENSIONS ARE IN MILLIMETERS				FINISH:		DEBUR AND BREAK SHARP EDGES		DO NOT SCALE DRAWING		REVISION	
SURFACE FINISH:											
TOLERANCES:											
LINEAR:											
LINEAR:											
ANGULAR:											
DRAWN		NAME		SIGNATURE		DATE		TITLE:		PVC SADDLE CLAMP FOR PVC PIPE -THREAD OUTLET	
CHK'D								MANUFACTURER		QINGDAO JUDBERD MACHINERY CO LTD	
APP'VD								SCALE:		SHEET 1 OF 1	
MFG								WEIGHT:			
Q.A											

