

**WASHER AS PER DIN125,
 CARBON STEEL GRADE 4.8/6.8/8.8
 WITH DACROMET THICKNESS
 8-10UM/HOT DIP GALVANIZATION
 30-40UM/STAINLESS STEEL
 A2/A4 OR AS PER
 CLIENT REQUIREMENT**

**BODY
 DUCTILE IRON EN GJS450-10
 AS PER EN1563 OR
 OTHERS AS PER CLIENT
 REQUIREMENT**

**GASKET
 EPDM AS PER EN681-1
 OR NBR AS PER EN682**

**NUTS AS PER DIN934,
 CARBON STEEL GRADE
 4.8/6.8/8.8 WITH DACROMET
 THICKNESS 8-10UM/HOT
 DIP GALVANIZATION
 30-40UM/STAINLESS STEEL
 A2/A4 OR AS PER
 CLIENT REQUIREMENT**

**BOLTS AS PER DIN 933, CARBON STEEL
 GRADE 4.8/6.8/8.8 WITH DACROMET
 THICKNESS 8-10UM/HOT DIP
 GALVANIZATION 30-40UM/STAINLESS
 STEEL A2/A4 OR AS
 PER CLIENT REQUIREMENT**

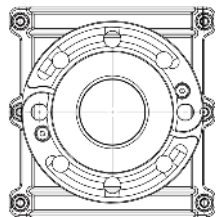
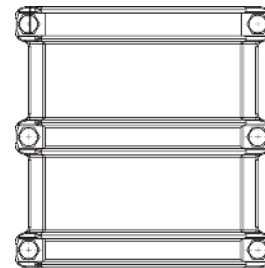
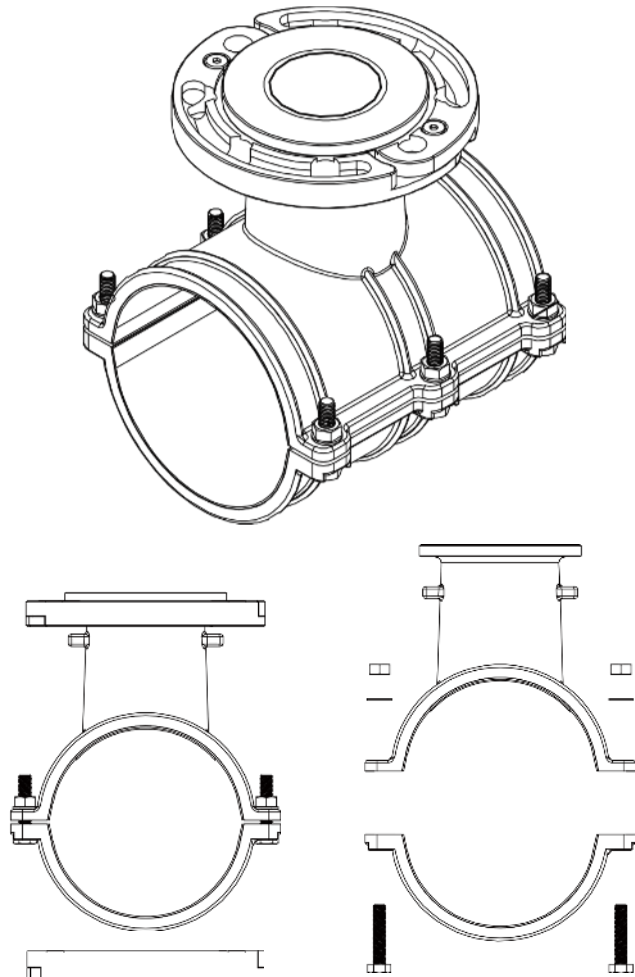

PRECAUTIONS

- 1, Suitable for PE and PVC pipes.
- 2, Sealing is achieved by compressing the EPDM gasket between saddle clamp body and pipe surface. The opening and closing of the branch pipeline are controlled by flange end isolation valve.
- 3, Medium conveyed can be water, oil or gas.

UNLESS OTHERWISE SPECIFIED, DIMENSIONS ARE IN MILLIMETERS		FINISH:		DEBUR AND BREAK SHARP EDGES		DO NOT SCALE DRAWING		REVISION	
SURFACE FINISH:									
TOLERANCES:									
LINEAR:									
LINEAR:									
ANGULAR:									
DRAWN	NAME	SIGNATURE	DATE			TITLE: SADDLE CLAMP FOR HDPE AND PVC PIPE - LOOSE FLANGE OUTLET			
CHK'D									
APP'VD									
MFG									
Q.A					MATERIAL:	MANUFACTURER QINGDAO JUDBERD MACHINERY CO LTD			
					WEIGHT:	SCALE:		SHEET 1 OF 1	

